

## 100-Acre Commercial Parcel

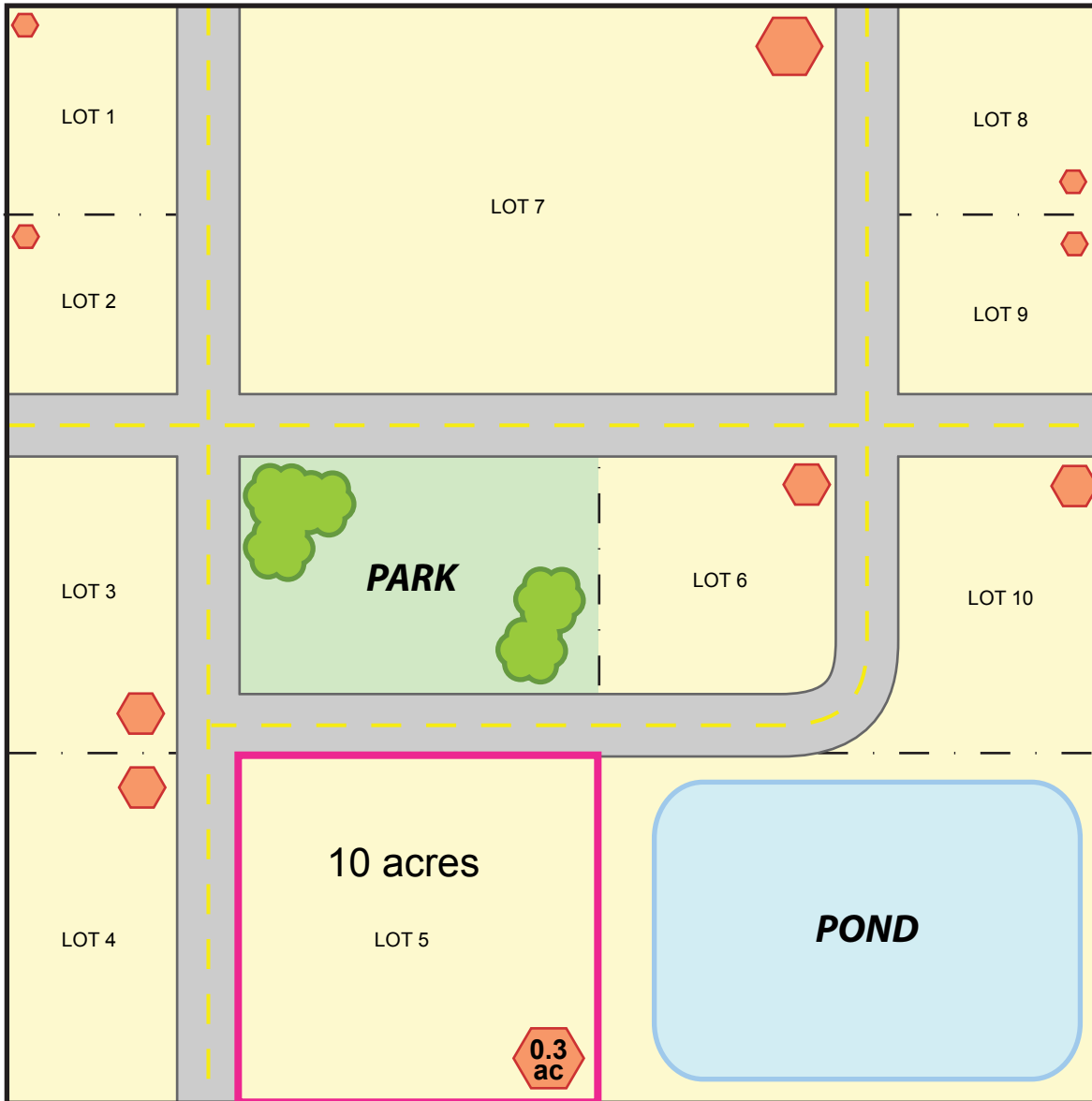

 **Infiltration Sites (Size determined by % lot area dedicated to infiltration)**

## Sizing Commercial Infiltration Sites (Rain Gardens):

- 1 • Calculate area of Developable Land  
(=Total Parcel - All Open Space - Roads)
- 2 • Assume 2% of Total Parcel Area dedicated to infiltration (per NR151)
- 3 • Total Parcel Area x (0.02/Developable Area) = % of each lot dedicated to infiltration
- 4 • Example:  
100 ac parcel  
- Area Open Space (park & pond) = 25  
- Area of Roads = 8  

---

= 67 acres (developable area)  
  
**Area of Infiltration** = (100-25) ac x (0.02/67 ac) = **0.0223**  
  
2.2% of each lot in this parcel needs to be dedicated to infiltration  
  
A 10-acre lot (435,600 sf) would need to dedicate 0.223 ac (9,713.9 sf) to infiltration
- 5 • This is only a starting point for determining infiltration area. Dane County has eliminated the 2% cap for commercial purposes and requires that the infiltration standard be satisfied, regardless of area to be dedicated OR that a secondary standard of “recharge” be met (see Dane County Code of Ordinances Chapter 14: Manure Management, Erosion Control and Stormwater Management)